

# TOOL ALLOYS

## DATA SHEET CPM® 1 V

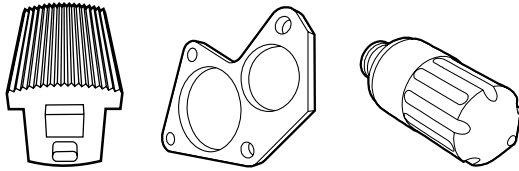

CERTIFIED TO ISO 9001



### CHEMICAL COMPOSITION

Carbon	0.55 %
Chromium	4.55 %
Vanadium	1.00 %
Molybdenum	2.75 %
Tungsten	2.15 %
Manganese	0.50 %

### CPM® 1 V

is a medium carbon, high alloy tool steel which exhibits high toughness combined with high heat resistance. It is suited for hot or cold applications demanding high impact toughness which also require moderate wear resistance. CPM® 1 V is produced by the special Crucible Particle Metallurgy Process. The microstructure gives CPM® 1 V high impact toughness. The vanadium content imparts CPM® 1 V a wear resistance slightly better than H11 or S7. Because of its high alloy composition, CPM® 1 V has temper resistance similar to high speed steel (M2) and much better than most typical hot work tool steels.

### TYPICAL APPLICATIONS

- \_ Blanking and punching, even for thicker sheet metals
- \_ Hot heading dies
- \_ Dies and forging tools
- \_ Thread rolling tools
- \_ Plastic injection dies and inserts
- \_ Extrusion moulding

### PHYSICAL PROPERTIES

Modulus of elasticity E [kN/mm <sup>2</sup> ]	207
Specific weight [kg/dm <sup>3</sup> ]	7.92
Coefficient of thermal expansion over temperature range of 20 - 400 °C [mm/mm °C]	12.1 x 10 <sup>-6</sup>

### POWDER METALLURGICAL AND CONVENTIONAL MICROSTRUCTURE

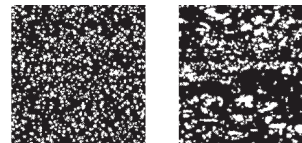

The uniform distribution of carbides in the powder-metallurgical structure compared to conventional tool steels with big carbides and carbide clusters.

### TOUGHNESS

Charpy C-Notch impact test

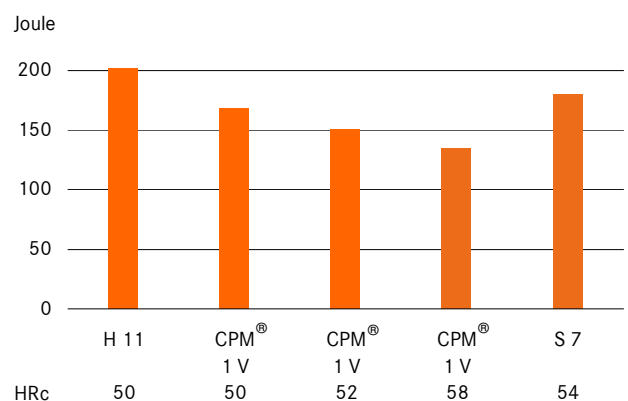

Standard size of the Charpy-test-piece with a 12.7 mm notch radius.

### WEAR RESISTANCE

Crossed Cylinder wear test

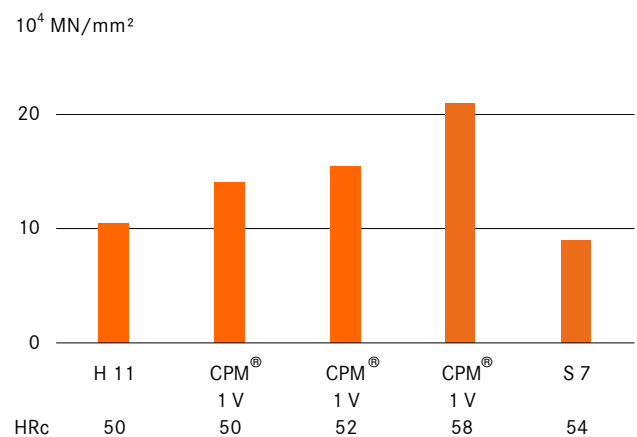

Reciprocal of wear rate in wear test with non lubricated crossed cylinder in contact with a rotation tungsten carbide cylinder.

## HEAT TREATMENT

### ANNEALING

CPM® 1 V is heated slowly and uniform to a temperature of 900 °C, maintain the temperature for 2 hours and allow to cool to 590 °C in the furnace at a cooling rate no faster than 15 °C. It is then further cooled in still air down to room temperature. The typical annealed hardness achieved by a soft annealing is approx. HB190.

### STRESS RELIEVING

Stress relieving follows rough machining by heating to 600-700 °C. Once complete heat penetration has been reached, the material is allowed to cool in the furnace to approx. 500 °C followed by cooling in air.

### HARDENING

Hardening CPM® 1 V usually involves the use of 2 preheating stages (450 – 500 °C/ 850 – 900 °C). Immediately following this it is heated to the required austenitizing temperature of 1065 – 1120 °C. Maximum toughness is attained at a temperature of 1065 °C, whilst maximum wear resistance is attained at the temperature of 1120 °C. In order to achieve a corresponding degree of dissolution of the alloy elements, a minimum heat penetration time of 20 minutes for hardening at 1065 °C is recommended, or 15 minutes for hardening at 1120 °C. These holding times should be correspondingly adapted for thick or thin walled material cross-sections.

### QUENCHING

Air, hot bath or interrupted oil quenching can be used. In case of vacuum heat treatment, due regard is to be given to applying an appropriate quenching rate (at least at 5 bar pressure). For attaining ideal toughness properties it is recommended to apply the bath quenching method.

### TEMPERING

Immediately temper after the material has cooled down below 40°C. Triple tempering with a holding time of 2 hours in each stage at the tempering temperature is necessary. Normally CPM® 1 V is tempered with a temperature range of 540 – 550 °C.

### TEMPERING DIAGRAM

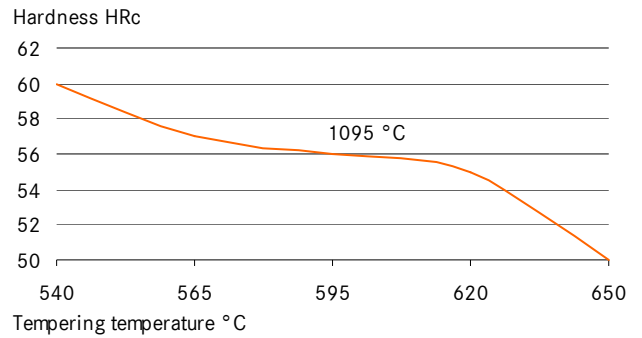

### HEAT TREATMENT INSTRUCTIONS

1st preheating	450-500 °C
2nd preheating	850-900 °C
Hardening	As specified in table
Tempering	3 x each 2 hours as specified in table

Quenching after hardening in hot bath at approx. 550°C or in vacuum at least at 5 bar overpressure.

Required hardness HRc ± 1	Austenitizing temperature °C	Holding time at austenitizing temperature minutes*	Tempering temperature[°C]
50	1095	20	650
55	1095	20	620
57	1095	20	600
58	1095	20	560
58	1065**	30	540
60	1095	20	540
61	1120	15	540

\* Previous preheating at 870 °C. The data preferred to 13 mm round bar samples. The holding times at austenitizing temperature should be correspondingly adapted for large and very thin profile dimensions. The maximum permissible austenitizing temperature of 1120 °C must not be exceeded.

\*\*Best combination of wear resistance/ toughness.

## MACHINING DATA

### TURNING

Cutting parameter	Turning with cemented carbide		HSS
	medium turning	finish turning	
Cutting speed ( $V_c$ ) m/min.	100-150	150-200	12-15
Feed (f) mm/U	0.2-0.4	0.05-0.2	0.05-0.3
Cutting depth ( $a_p$ ) mm	2-4	0.05-2	0.5-3
Tools according ISO	P 10-P 20*	P 10*	-

\* Use wear resistant coated cemented carbide, e.g. Coromant 4015 or Seco TP 100.

### MILLING

#### FACE- AND EDGEMILLING

Cutting parameter	Milling with cemented carbide		HSS
	Medium turning	finish turning	
Cutting speed ( $V_c$ ) m/min.	90-120	120-150	15
Feed (f) mm/U	0.2-0.3	0.1-0.2	0.1
Cutting depth ( $a_p$ ) mm	2-4	1-2	1-2
Tools according ISO	K 15*	K 15*	-

\* Use wear resistant coated cemented carbide, e.g. Coromant 4015 or Seco TP 100.

#### END MILLING

Cutting parameter	Solid carbide	Milling cutter w. indexable tips		Coated HSS
Cutting speed ( $V_c$ ) m/min.	45-55	90-110	12*	
Feed (f) mm/U	0.01-0.20**	0.06-0.20**	0.01-0.30**	
Tools according ISO	K 20	P 25***	-	

\* for TiCN-coated end mills made of HSS  $V_c \sim 25-30$  m/min.

\*\* depends on radial depth of cut and on milling cutter - diameter

\*\*\* Use wear resistant coated cemented carbide, e.g. Coromant 3015 or SECO T15M.

### DRILLING

#### SPIRAL DRILL MADE OF HSS

Driller- $\phi$ mm	Cutting speed ( $V_c$ ) m/min.	Feed (f) mm/U
0 - 5	5 - 8*	0.05-0.15
5 - 10	5 - 8*	0.15-0.25
10 - 15	5 - 8*	0.25-0.35
15 - 20	8 - 8*	0.35-0.40

\* for TiCN-coated end mills made of HSS  $V_c \sim 25-30$  m/min.

#### CARBIDE METAL DRILLER

Cutting parameter	Drill type		Coolant bore driller with carbide tip*
	Insert drill	solid carbide tip	
Cutting speed ( $V_c$ ) m/min.	80-110	40	35
Feed (f) mm/U	0.08-0.14**	0.10-0.15**	0.10-0.20**

\* driller with coolant bores and a soldered on carbide tip

\*\* depends on driller-diameter

### GRINDING

Grinding method	soft annealed	hardened
	Surface grinding, straight grinding wheels	A 13 HV
Surface grinding	A 24 GV	3SG 36 HVS**
Cylindrical grinding	A 60JV	B126 R75 B3* 3SG 60 KVS** A 60 IV
Internal grinding	A 46 JV	B126 R75 B3* 3SG 80 KVS** A 60 HV
Profile grinding	A 100 LV	B126 R100 B6* 5SG 80 KVS** A 120 JV

\* for these applications we recommend CBN-wheels

\*\* grinding wheel from the company Norton Co.

# TOOL ALLOYS STOCK LIST CPM<sup>®</sup> 1 V

# ZAPP

CERTIFIED TO ISO 9001

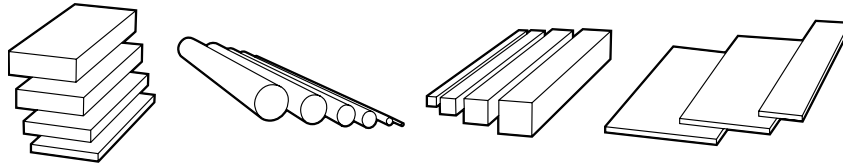

The sizes indicated below are usually available in a machined execution and can be considered as finished sizes.

## ROUND BAR DIMENSIONS

	155.0 mm
25.7 mm	170.0 mm
32.1 mm	206.3 mm
38.4 mm	244.4 mm
45.2 mm	281.0 mm
51.5 mm	
64.2 mm	
77.0 mm	
90.0 mm	
94.0 mm	
103.1 mm	
128.5 mm	
135.0 mm	
153.9 mm	

## FLAT BAR DIMENSIONS

### in thicknesses

101.6 mm
155.0 mm

Further dimensions are available within  
3-4 weeks after request.

## ZAPP MATERIALS ENGINEERING

### TOOL ALLOYS

Robert Zapp Werkstofftechnik GmbH

Zapp-Platz 1

40880 Ratingen

P.O. Box 10 18 62

40838 Ratingen

Germany

Phone +49 2102 710-591

Fax +49 2102 710-596

toolalloys@zapp.com

## SERVICE CENTER

Hochstraße 32

59425 Unna

Germany

Phone +49 2304 79-511

Fax +49 2304 79-7652

www.zapp.com

Further information regarding our products and locations are available in our image brochure and under [www.zapp.com](http://www.zapp.com)

The technical information, illustrations, drawings, dimensional and weight data and any other data presented in this data sheet/ stock list shall only describe our products and are deemed to be noncommittal average values. They do neither represent any specification as to the quality of our products nor constitute any guarantee of quality or durability. The presented applications exclusively suit illustration purposes and can neither be considered to constitute a guarantee as regards to the feasibility of materials nor to qualify as specification regarding quality. The information given cannot substitute a detailed consultancy concerning the selection of our products and the usability for the intended implementation. This data sheet/ stock list is not subject to a revision service.

Issue: October 2006